

MRA500系列
使用說明書  

TOOL FREE SCREW-LESS
[HDD-ROM] 4 x3.5" SATA 硬碟抽取盒

產品規格&包裝內容

MRA501AS



產品規格

作業系統: Windows/Mac
傳輸介面: SATA
傳輸速率: 6.0Gbps(SATA III)
重量: 1366g
外觀尺寸: 195(L)x148(W)x127(H)mm
工作溫度: 0~55°C
LED 燈號: 藍色電源指示, 橙色讀取指示

包裝內容

鑰匙 x2
螺絲 x8
說明書 x1
SATA數據線 x4
SATA Y型電源線 x2

MRA500AS



產品規格

作業系統: Windows/Mac
傳輸介面: SATA
傳輸速率: 6.0Gbps(SATA III)
重量: 1352g
外觀尺寸: 195(L)x148(W)x127(H)mm
工作溫度: 0~55°C
LED 燈號: 藍色電源指示, 橙色讀取指示

包裝內容

螺絲 x8
說明書 x1
SATA數據線 x4
SATA Y型電源線 x2

MRA502AS



產品規格

作業系統: Windows/Mac
傳輸介面: SATA
傳輸速率: 6.0Gbps(SATA III)
重量: 1582g
外觀尺寸: 195(L)x148(W)x127(H)mm
工作溫度: 0~55°C
LED 燈號: 藍色電源指示, 橙色讀取指示

包裝內容

鑰匙 x2
螺絲 x8
說明書 x1
SATA數據線 x4
SATA Y型電源線 x2

MRA500ALS



產品規格

作業系統: Windows/Mac
傳輸介面: SATA
傳輸速率: 6.0Gbps(SATA III)
重量: 1638g
外觀尺寸: 195(L)x148(W)x127(H)mm
工作溫度: 0~55°C
LED 燈號: 藍色電源指示, 橙色讀取指示
面板材質: 鋁面板

包裝內容

鑰匙 x2
螺絲 x8
說明書 x1
SATA數據線 x4
SATA Y型電源線 x2

產品說明&前面板

1: MRA501AS

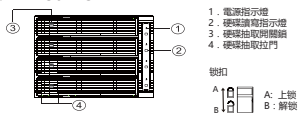

1. 電源指示燈
2. 硬碟讀取指示燈
3. 硬碟抽取開鎖鈕
4. 硬碟抽取拉門

拉門開啟方式: 使用鑰匙對準面板上的鎖孔向下撥至解鎖狀態, 拉開抽取拉門, 取出硬碟。

2: MRA500AS

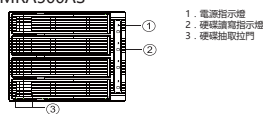

1. 電源指示燈
2. 硬碟讀取指示燈
3. 硬碟抽取拉門

拉門開啟方式: 拉開抽取拉門, 取出硬碟。

3: MRA502AS

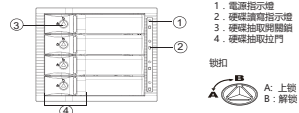

1. 電源指示燈
2. 硬碟讀取指示燈
3. 硬碟抽取開鎖鈕
4. 硬碟抽取拉門

拉門開啟方式: 使用鑰匙解開三角鎖 (順時針旋轉90度), 打開硬碟蓋門。

4: MRA500ALS

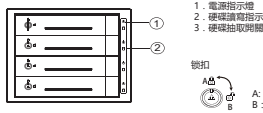

1. 電源指示燈
2. 硬碟讀取指示燈
3. 硬碟抽取開鎖鈕

拉門開啟方式: 使用鑰匙解開三角鎖 (順時針旋轉90度), 打開硬碟蓋門。

後面板

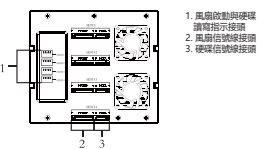

1. 風扇啟動與硬碟讀取指示燈
2. 風扇溫度指示燈
3. 風扇溫度調整旋鈕
4. 硬碟抽取拉門

連接

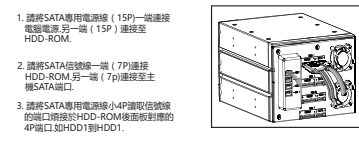

1. 請將SATA專用電源線 (15P) 一端連接電腦電源另一端 (15P) 連接至HDD-ROM。
2. 請將SATA數據線一端 (7P) 連接HDD-ROM另一端 (7P) 連接至主機SATA端口。
3. 請將SATA專用電源線小4P讀取信號線插入口插於HDD-ROM後部接收對應的4P插口如HDD1到HDD4。

安裝步驟

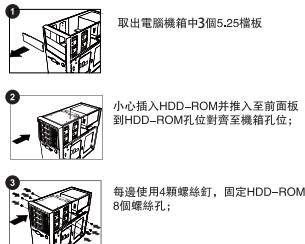

1. 取出電腦機箱中3個5.25槽板
2. 小心插入HDD-ROM並推入至前面板到HDD-ROM孔位對齊至機箱孔位;
3. 每邊使用4顆螺絲釘, 固定HDD-ROM 8個螺絲孔;

放置硬碟到HDD-ROM

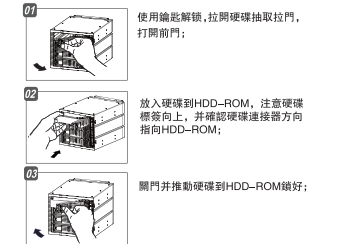

01. 使用鑰匙解鎖, 拉開硬碟抽取拉門, 打開前門;
02. 放入硬碟到HDD-ROM, 注意硬碟標籤向上, 並確認硬碟連接器方向指向HDD-ROM;
03. 關門並推動硬碟到HDD-ROM鎖好;



退出硬碟步驟

1. 如HDD-ROM有上鎖, 使用鑰匙解鎖, 拉開硬碟抽取拉門, 打開前門。
2. 將硬碟從HDD-ROM中取出(硬碟表面溫度可能高達50°C, 請勿直接接觸, 但需小心, 請接好硬碟的數據線, 不要觸摸下面的電路板)。
3. 關好前門, 使用鑰匙鎖定。

產品使用注意事項

1. 風扇電源必須插入, 否則有可能高溫損壞硬碟。
2. 如果硬碟插入方向錯誤, 請不要硬闖前門, 如執行強行HDD-ROM會被損壞。
3. 在使用HDD-ROM時請按硬碟前安裝SATA界面熱插拔相關驅動程式及碟碟管理軟體。
4. 如果操作系統在硬碟是裝置HDD-ROM之內, 祇有在關閉電源的情況下能抽換該硬碟。

MRA5 00 Series

User Manual  

TOOL FREE SCREW-LESS
[HDD-ROM] 4x3.5" SATA Enclosure

Specifications & Package content

MRA501AS



Specifications

Operating Systems: Windows/Mac
Interface: SATA
Transfer speed: 6.0Gbps(SATA III)
Product weight: 1366g
Dimensions: 195(L)x148(W)x127(H)mm
Operation temperature: 0~55°C
LED indicator: Blue LED for Power, Orange LED for Activity

Package content

Key x2
Frame Screws x8
User Manual x1
SAT Data Cable x4
SATA Power Y Cable x2

MRA500AS



Specifications

Operating Systems: Windows/Mac
Interface: SATA
Transfer speed: 6.0Gbps(SATA III)
Product weight: 1352g
Dimensions: 195(L)x148(W)x127(H)mm
Operation temperature: 0~55°C
LED indicator: Blue LED for Power, Orange LED for Activity

Package content

Frame Screws x8
User Manual x1
SAT Data Cable x4
SATA Power Y Cable x2

MRA502AS



Specifications

Operating Systems: Windows/Mac
Interface: SATA
Transfer speed: 6.0Gbps(SATA III)
Product weight: 1582g
Dimensions: 195(L)x148(W)x127(H)mm
Operation temperature: 0~55°C
LED indicator: Blue LED for Power, Orange LED for Activity

Package content

Key x2
Frame Screws x8
User Manual x1
SAT Data Cable x4
SATA Power Y Cable x2

MRA500ALS



Specifications

Operating Systems: Windows/Mac
Interface: SATA
Transfer speed: 6.0Gbps(SATA III)
Product weight: 1638g
Dimensions: 195(L)x148(W)x127(H)mm
Operation temperature: 0~55°C
LED indicator: Blue LED for Power, Orange LED for Activity
Panel material: Aluminum panel

Package content

Key x2
Frame Screws x8
User Manual x1
SAT Data Cable x4
SATA Power Y Cable x2

Front view

1: MRA501AS

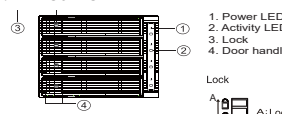

1. Power LED
2. Activity LED
3. Lock
4. Door handle

Lock: Insert the key to the keyhole and press it down to unlock the HDD enclosure.

2: MRA500AS

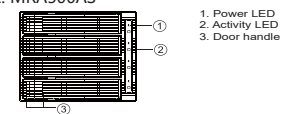

1. Power LED
2. Activity LED
3. Door handle

3: MRA502AS

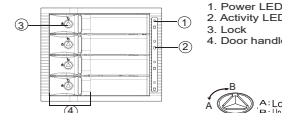

1. Power LED
2. Activity LED
3. Lock
4. Door handle

Lock: Use the key to unlock it by rotating the key 90 degrees clockwise.

4: MRA500ALS

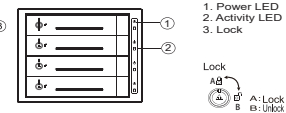

1. Power LED
2. Activity LED
3. Lock

Lock: Use the key to unlock it by rotating the key 90 degrees clockwise.

Back view

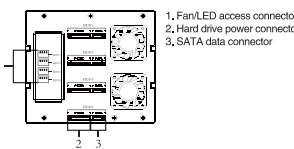

1. Fan/LED access connector
2. Hard drive power connector
3. SATA data connector

Connect the cables

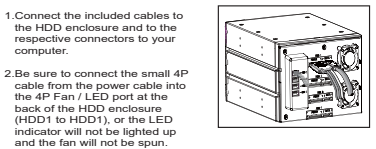

1. Connect the included cables to the HDD enclosure and to the respective connectors to your computer.
2. Be sure to connect the small 4P cable from the power cable into the 4P Fan / LED port at the back of the HDD enclosure (HDD1 to HDD4), or the LED indicator will not be lighted up and the fan will not be spun.

Hardware Installation

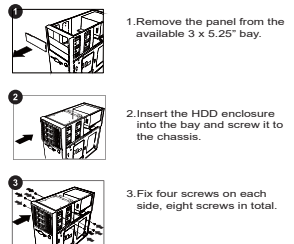

1. Remove the panel from the available 3 x 5.25" bay.
2. Insert the HDD enclosure into the bay and screw it to the chassis.
3. Fix four screws on each side, eight screws in total.

HDD Installation

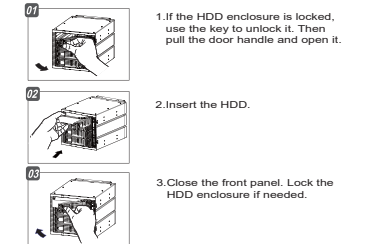

1. If the HDD enclosure is locked, use the key to unlock it. Then pull the door handle and open it.
2. Insert the HDD.
3. Close the front panel. Lock the HDD enclosure if needed.

Ejecting the HDD

1. If the HDD enclosure is locked, use the key to unlock it. Then pull the door handle and open it.
2. Remove the HDD, close the front panel. Lock the HDD enclosure if needed.

Note

1. Hard drive is a precision device, please read the HDD manual in advance before use.
2. Do not force to close the door if inserting the HDD in wrong direction, or the HDD enclosure will be damaged.
3. Do not remove the hard drive during working condition.
4. Be aware of the heat since the hard drive may reach temperature up to 50°C.
5. We provide repair service for defective product, and do not take responsibility for data loss that caused by manual operation mistake.