

MRA367

8x2.5" SATA/SAS硬碟抽取盒



使用說明書

產品說明

開關鍵



用鑰匙解開三角鎖(順時針旋轉90度)即可。

前面板

1. 硬碟抽取開關鎖
2. 把手卡扣
3. 硬碟讀寫指示燈

後面板

1. SATA電源插槽
2. Mini SAS 接口 (SFF8087)
3. 風扇

包裝內容:

- MRA367 (x1)
- 機殼固定螺絲 (x8)
- 硬碟固定螺絲 (x32)
- 說明書 (x1)
- 鑰匙 (x4)

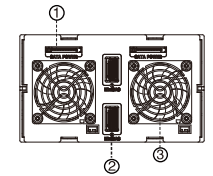
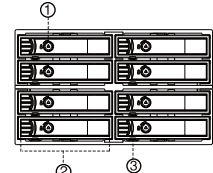
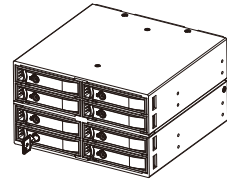

產品規格:

產品名稱:MRA367
 作業系統:Windows/Mac
 傳輸介面:支援SATA I/II/III(6.0Gb/s)
 適用於2.5" SATA/SAS/SSD硬碟, 支持7~15mm厚度
 電源指示燈:通電插入硬碟後藍色指示燈長亮
 讀寫指示燈:藍色指示燈閃爍
 風扇:風扇故障報警時,紅藍交替閃爍
 支援熱插拔
 重量:1450g
 產品尺寸:160(L)x146(W)x85(H)mm
 工作溫度:0~55°C

安裝

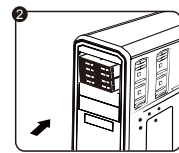
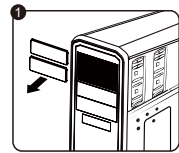

1. 卸下電腦機箱前方2x5.25"空槽面板。(CD-ROM 空间)
2. 小心插入MRA367 並推至底使之與機箱前面板平齊, MRA367孔位與機箱孔位對齊。

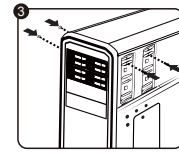

3. 每邊使用4個螺絲,8孔固定。

連接

1. 請將電腦機箱電源上的SATA電源線連接至MRA367之電源端口。
2. 請將Mini SAS SFF8087 to SFF8087線一端連接MRA367,另一端插入PCI/PCIE Mini SAS 擴展卡,如圖:
(注:本產品不含SAS擴展卡及MiniSAS線材)

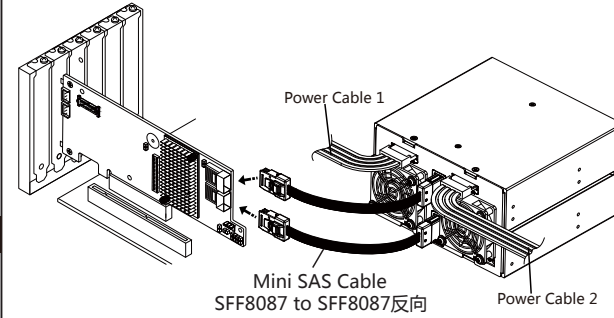

由於8顆硬碟同時工作所需電力功率較大,請使用兩條獨立的電源線。

安裝硬碟基本步驟

1. 用鑰匙解開三角鎖(順時針旋轉),拉開硬碟抽取拉門,打開前門。

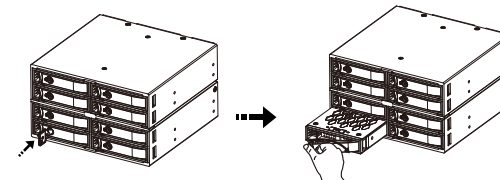

Connect the cables

Connect the MRA367 to the SAS host with two SAS cables and to power with two SATA power cables. (Note : PCI/PCIE MiniSAS card and Mini SAS cable are not included in MRA367)

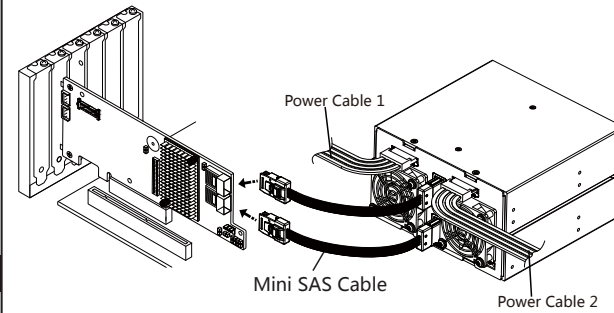

It requires more power to allow eight hard drives working at the same time, be sure to power with two separate SATA power cables.

HDD Installation

1. If the door is locked, use the key to unlock it. Squeeze the latch to release the door handle, pull the door handle open.

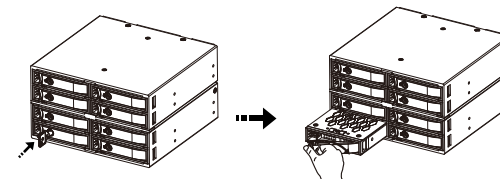

2. 取出Tray,放入2.5" 硬碟鎖上螺絲,再把Tray放入外殼,關上面板。

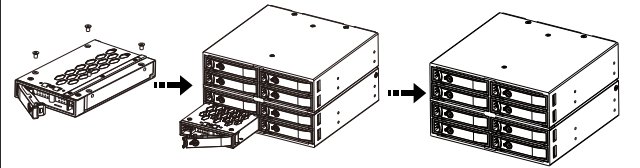

1. 插入硬碟並關上面板時,請小心輕輕推動前面板至鎖住狀態,以免機構零件受損。
2. 如果硬碟插入方向錯誤,請不要關閉前門,如強行關閉MRA367 會被損害。

卸下硬碟步驟

1. 使用鑰匙解開三角鎖(順時針旋轉90度),拉開硬碟抽取拉門,打開前門。
2. 取出Tray,取出2.5" 硬碟,再把Tray放回機身,關上面板。

聲明

用戶手冊所包含的內容均受到版權法的保護未經本公司的批准,任何組織或個人不得以任何手段或形式對其進行複製,存於資料庫或檢索系統,對於在使用硬碟抽取盒過程中所造成的任何損失,本公司概不負責。

MRA367

8 x 2.5" SATA/SAS HDD Enclosure



User Manual

Product diagram

Lock



Use the key to unlock it by rotating the key 90 degrees clockwise.

Front view

1. Lock
2. Tray release latch
3. LED indicator

Back view

1. SATA power port
2. Mini SAS port SFF8087
3. Fan

Package Content:

- Frame screws (x8)
- HDD tray screws (x32)
- key (x4)
- User manual (x1)

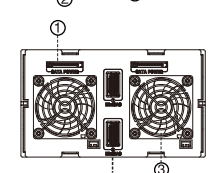
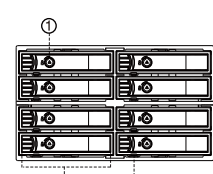
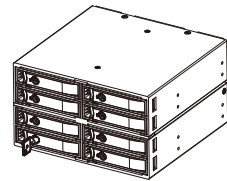

Specifications

Operating Systems : Windows/Mac
 Interface : Support SATA I/II/III(6.0Gb/s)
 Supported HDD type : 8 x 2.5" SATA/SAS HDD, 7~15mm
 Assembly Space : 2 x 5.25" CD-ROM space
 LED indicator :
 Solid blue for power and blinking blue for HDD access.
 Blinking red for Fan malfunction, alternating red and blue flashing.
 Material : Aluminum, SGCC, SUS430 stainless steel, PC
 Product Dimensions : 160(L)x146(W)x85(H)mm
 Product Weight : 1450g
 Operating Temperature : 0~55°C
 Application : Industrial servers ; Professional storage products

Hardware Installation

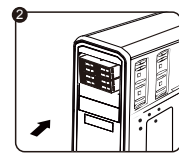
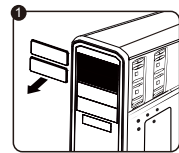

1. Remove the panel from the available 2 x 5.25" bay
2. Insert the MRA367 into the bay and screw it to the chassis.

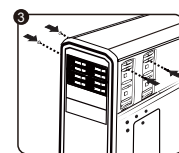

3. Fix four screws on each side, eight screws in total.