

MRA260E 2.5" to 3.5" 轉接盒

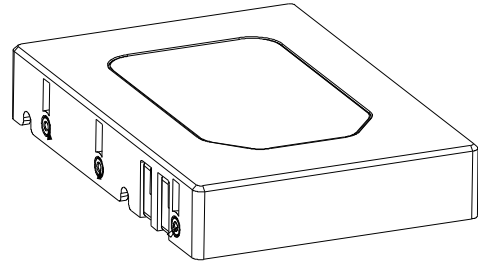

使用說明書 UserManual



產品特點

- 1.本產品外形尺寸與3.5" HDD相同，2.5" HDD 裝入本產品中後可直接置於使用3.5" HDD的任一產品中完成轉接
2. 7mm、9.5mm、15mm 高度的SATA\SAS 硬碟均可相容

產品規格

- 1.重量:128g
- 2.外觀尺寸:101.6x146x25mm
- 3.材質:塑膠，五金
- 4.工作溫度:0°C-55°C

包裝內容

附件	數量
MRA260E	1pcs
使用說明書	1pcs
2.5" 硬碟螺絲	2pcs
3.5" 硬碟螺絲	4pcs

產品說明

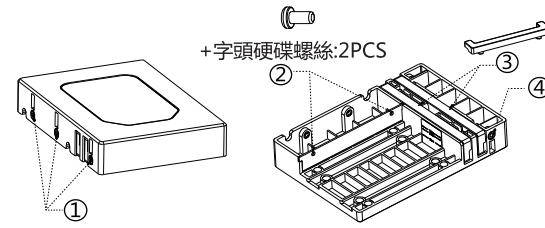

1. 3.5" 硬碟螺絲孔
2. 2.5" 硬碟螺絲孔
3. 高度調節塊 2Pcs
4. 3.5" 硬碟螺絲孔

基本使用

1. 安裝硬碟到MRA260E,如圖所示:

1) 裝厚度7mm 硬碟時

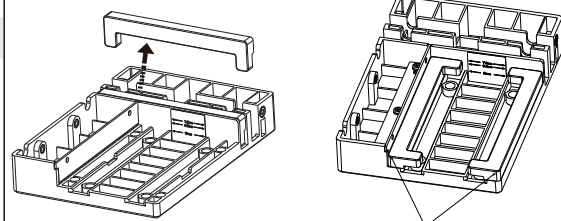

A. 向上取出調節塊 B. 按視圖方向將調節塊裝於本體安裝位置

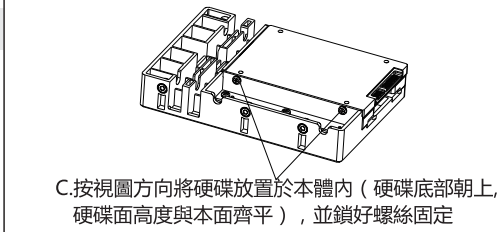

C. 按視圖方向將硬碟放置於本體內(硬碟底部朝上, 硬碟面高度與本面齊平), 並鎖好螺絲固定

2) 裝厚度9.5mm 硬碟時

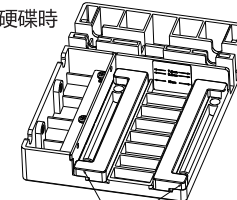

B. 按視圖方向將調節塊裝於本體安裝位置 (A:C: 兩步驟同7.0mm 硬碟安裝方法)

3) 裝厚度15mm 硬碟時

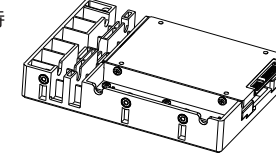

C. 按視圖方向將硬碟放置於本體內(硬碟底部朝上), 並鎖好螺絲固定(裝15mm 硬碟時, 不需要調節塊, 建議將調節塊放回原位。)

2. 將MRA260E置於Wingsonic公司生產的3.5" 內置或外置的任一產品中, 如MRA201/MRA400/MRA503/MRA504/MRA505等產品中

例如:

a. 將MRA260E置於產品MRA201中, 如圖:

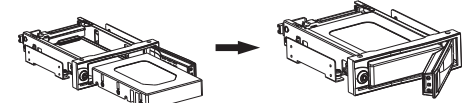

b. 將MRA260E置於產品MRA503中, 如圖:

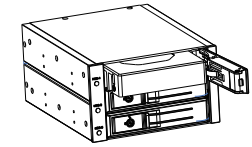

注意事項

1. 使用不同厚度硬碟時, 注意調節塊放入對應的位置, 硬碟面高度與本體面齊平。
2. 硬碟表面溫度有可能高達50°C, 請小心注意。
3. 硬碟是精密設備, 要特別注意, 請預先閱讀硬碟使用說明書。
4. 當工作狀態下禁止卸下硬碟。
5. 請勿在產品內部放置雜物。
6. 對於本產品故障問題, 本公司提供維修服務, 但不承擔對其它軟硬碟的損害或資料遺失等責任。

MRA260E 2.5" to 3.5" Converter

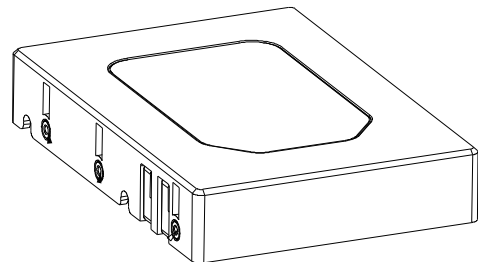

UserManual



Features

1. Size same as 3.5" HDD. Install one 2.5" HDD and convert into a 3.5" HDD that fits any 3.5" enclosure.
2. Fits 7mm / 9.5mm / 15mm SATA/SAS HDD

Specifications

1. Weight : 128g
2. Dimensions : 101.6x146x25mm
3. Material : Plastic / Metal
4. Operating Temperature : 0°C-55°C

Package content

MRA260E x 1
User Manual x 1
Screws for 2.5" HDD x 2
Screws for 3.5" HDD x 4

Product diagram

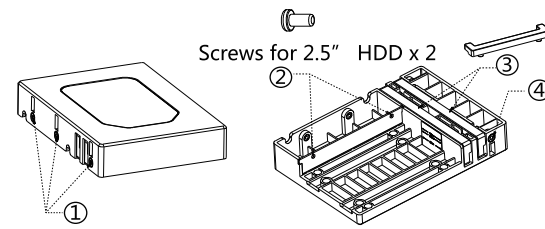

1. Screw holes for 3.5" HDD
2. Screw holes for 2.5" HDD
3. Adjustment blocks x 2
4. Screw holes for 3.5" HDD

How to use

1. Install one 2.5" drive into the converter

1) Install a 7mm HDD

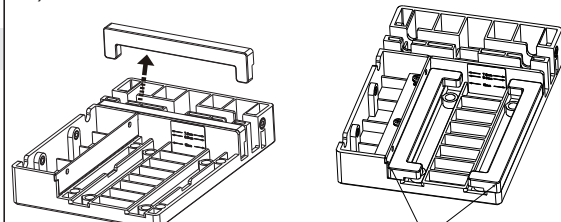

A. Remove the adjustment blocks B. Follow above instructed position to put the adjustment blocks

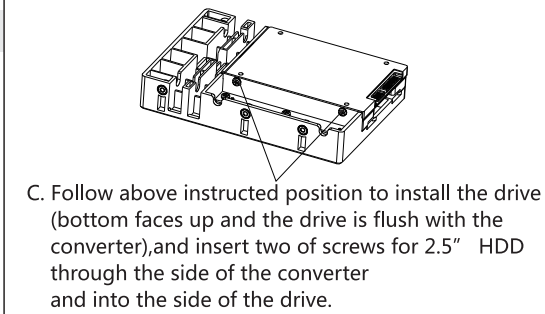

C. Follow above instructed position to install the drive (bottom faces up and the drive is flush with the converter), and insert two of screws for 2.5" HDD through the side of the converter and into the side of the drive.

2) Install a 9.5mm HDD

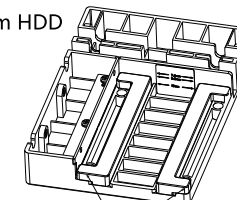

B. Follow above instructed position to put the adjustment blocks Follow 1) A. C.

3) Install a 15mm HDD

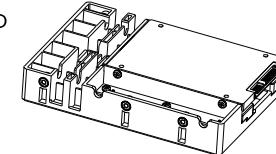

No need to use the adjustment blocks and follow 1) C.

2. Insert MRA260E to any 3.5" internal / external enclosure, or install it in a computer.

a. Insert MRA260E to MRA201, as below:

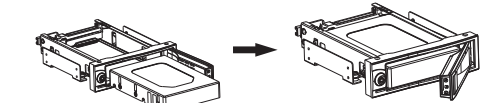

b. Insert MRA260E to MRA503, as below:

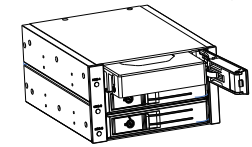

Note

1. When using different thickness drive, be aware to put the adjustment blocks into the corresponding position and make sure the drive is flush with the converter
2. Be aware of the heat since the drive may reach temperature up to 50 ° C.
3. Hard drive is a precision device, please read the HDD manual in advance before use.
4. Please do not remove the drive during working condition.
5. Do not place any objects inside the product.
6. We provide repair service for defective product, and do not take responsibility for data loss that caused by manual operation mistake.